

SECTION ON - (D)

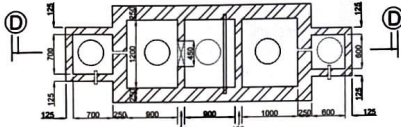

PLAN OF SEPTIC TANK FOR 30 USERS
SCALE: 1:50

PERMISSIBLE HEIGHT IN REFERENCE TO CC2M ISSUED BY AA: 33.0 M. CO-ORDINATE IN WGS 84 AND BITE ELEVATION (AMSL).		
CO-ORDINATE IN WGS 84		BITE ELEVATION (AMSL)
LATITUDE	LONGITUDE	
22° 30' 21.44" N	86° 18' 18.00" E	4.8 MTR.

THE ABOVE INFORMATION IS TRUE AND CORRECT IN ALL RESPECT AND IF AT ANY STAGE, IT IS FOUND OTHERWISE, THEN I SRI ANJAN BHASKAR SHALL BE FULLY LIABLE FOR WHICH K.M.C. AND OTHER APPROPRIATE AUTHORITY RESERVE THE RIGHT TO TAKE APPROPRIATE ACTION AGAINST ME AS PER LAW.

NAME OF L.B.S. : BHASKAR CHANDRA SINHA (1183)

NAME OF POWER OF ATTORNEY : "U. S. T. CONSTRUCTION" PARTNERSHIP SURAJIT CHATTERJEE & ARJIT CHATTERJEE

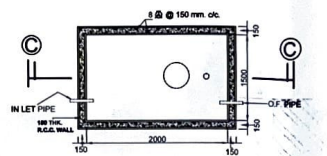

PLAN OF R.C.C. SEMI U/G. WATER RESERVOIR CAPACITY - 600 GLS.
SCALE: 1:50

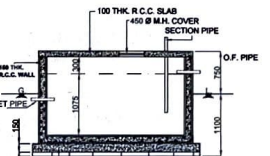

SECTION ON - (C)

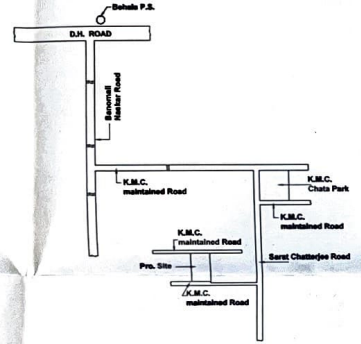

LOCATION PLAN
SCALE: 1:4000

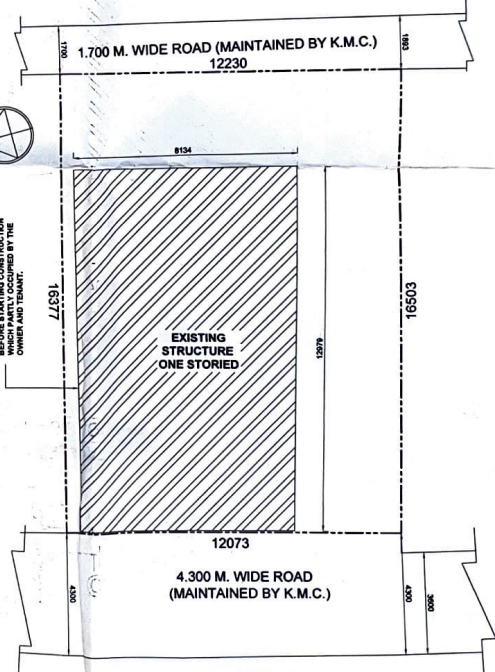

EX. SITE PLAN
SCALE: 1:100

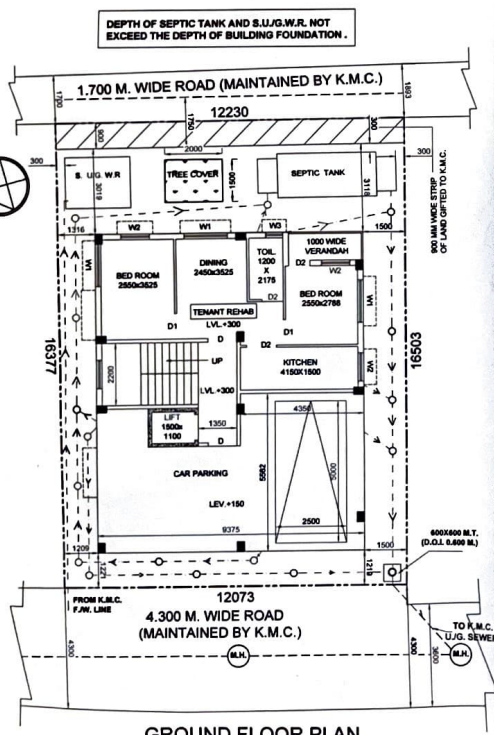

GROUND FLOOR PLAN

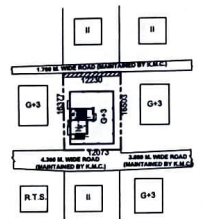

SITE PLAN
SCALE: 1:50

PLAN OF A PROPOSED 3+III STORED RESIDENTIAL BUILDING U/S - 393 (A) OF K.M.C. ACT 1980, COMPLYING BUILDING RULES 2009, AT PREMISES NO.- 162, SARAT CHATTERJEE ROAD, UNDER K.M.C. WARD NO.- 131, BOROUGH NO.- XIV.

NAME OF OWNERS :- SURAJIT CHATTERJEE, SUBHAJIT CHATTERJEE & ARJIT CHATTERJEE.

SCALE = 1:100, 1:50, 1:600, 1:4000

SPECIFICATION	SCHEDULE OF DOORS & WINDOWS			
	MRD.	WIDTH	HEIGHT	TYPE
1. GRADE OF CONCRETE IS M20	D	1000	2100	PANELLED
2. GRADE OF STEEL IS Fe 500.	D1	900	2100	PANELLED
3. BEARING CAPACITY OF SOIL. (AS PER SOIL REPORT).	D2	750	2100	PANELLED
4. 200 THK BRICK WORK SHOULD BE DONE IN SAND CEMENT MORTAR 6:1.	W1	1500	1200	GLAZED
5. 125 & 75 THK. BRICK WORK SHOULD BE DONE IN SAND CEMENT MORTAR 4:1.	W2	1000	1200	DO
6. ALL OTHERS AS PER I.S. CODE.	W3	600	700	DO

STATEMENT OF THE PLAN PROPOSAL

- ASSESSMENT NO - 41-131-17-0160-9
 - DETAILS OF REGISTERED DEED:
 - DEED NO. - 1773
 - VOL. NO. - 27
 - BOOK NO. - 1
 - DATE - 28.05.1971
 - PAGES - 275 TO 282, AT J.S.R. BEHALA
 - DETAILS OF POWER OF ATTORNEY:
 - DEED NO. - 18070944
 - VOL. NO. - 1807-2023
 - BOOK NO. - 1
 - DATE - 28.04.2023
 - PAGES - 145960 TO 145971, AT A. D.S.R. BEHALA
 - DETAILS OF BOUNDARY DECLARATION:
 - DEED NO. - 180712294
 - VOL. NO. - 1807-2023
 - BOOK NO. - 1
 - DATE - 12.10.2023
 - PAGES - 354579 TO 354591, AT A.D.S.R. BEHALA
 - DETAILS OF BACK STRIP DECLARATION:
 - DEED NO. - 180712295
 - VOL. NO. - 1807-2023
 - BOOK NO. - 1
 - DATE - 12.10.2023
 - PAGES - 354600 TO 354622, AT A.D.S.R. BEHALA
 - DETAILS NON EVICTION OF TENANT:
 - DEED NO. - 180712293
 - VOL. NO. - 1807-2023
 - BOOK NO. - 1
 - DATE - 12.10.2023
 - PAGES - 354838 TO 354847, AT A.D.S.R. BEHALA
 - AREA OF LAND AS PER DOCUMENTS:
 - 3 KH-0 CH-0 SFT. = 200.669 SQ.M.
 - AREA OF LAND AS PER B/D = 199.782 SQ.M.
 - CAR PARKING REQUIRED = 1 NO.
 - PROVIDED = 1 NO.
- DECLARATION OF L. B. S.
- CERTIFY WITH FULL RESPONSIBILITY THAT THE BUILDING PLAN HAS BEEN DRAWN UP AS PER PROVISION OF K.M.C. BUILDING RULES 2009, AS AMENDED FROM TIME TO TIME AND THAT THE SITE CONDITION INCLUDING WIDTH OF ABUTTING ROAD CONFORM WITH THE PLAN, WHICH HAS BEEN MEASURED AND VERIFIED BY ME. IT IS A BUILDABLE SITE NOT AT TANK OR FILLED UP A TANK. THE LAND IS DEMARCATED & BOUNDED BY BOUNDARY WALL. THE CONSTRUCTION OF U.G. WATER TANK AND SEPTIC TANK WILL BE COMPLETED BEFORE STARTING OF BUILDING FOUNDATION WORK.

DECLARATION OF E. S. E.

THE STRUCTURAL DESIGN AND DRAWING OF BOTH FOUNDATION AND SUPER STRUCTURE OF THE BUILDING HAS BEEN MADE BY ME CONSIDERING ALL POSSIBLE LOADS INCLUDING THE SEISMIC LOAD AS PER THE I.B.C. OF INDIA (LATEST REVISION) AND CERTIFIED THAT IT IS SAFE AND STABLE IN ALL RESPECT. SOIL TEST REPORT HAS BEEN DONE BY BHASKAR ROY, VASCON AT 67A, JADUNATH MUKHERJEE ROAD, KOLKATA-700034

BHASKAR ROY (P143)
NAME OF STRUC. ENGG.

DECL. OF POWER OF ATTORNEY

I, DO HEREBY DECLARE WITH FULL RESPONSIBILITY THAT WE, SHALL ENGAGE L.B.S AND E.S.E. DURING CONSTRUCTION. I SHALL FOLLOW THE INSTRUCTION OF L.B.S. AND E.S.E. DURING CONSTRUCTION OF THE BUILDING (AS PER B.S. PLAN) K.M.C. AUTHORITY WILL NOT BE RESPONSIBLE FOR STRUCTURAL STABILITY OF THE BUILDING. IF ANY SUBMITTED DOCUMENTS ARE FOUND TO BE FAKE, THE K.M.C. AUTHORITY WILL REVOKE THE SANCTION PLAN. THE CONSTRUCTION OF SEMI U/G. WATER RESERVOIR AND SEPTIC TANK WILL BE UNDERTAKEN UNDER THE GUIDANCE OF L.B.S. / E.S.E. BEFORE STARTING OF BUILDING FOUNDATION WORK. THE EX. STRUCTURE OCCUPIED BY OWNER.

SURAJIT CHATTERJEE
SUBHAJIT CHATTERJEE
ARJIT CHATTERJEE
NAME OF AUTHORIZED SIGNATORY

BUILDING PERMIT NO. :-2023140262 DATED :- 27.12.2023

VALID UPTO :- 26.12.2028

UTTAM PARAMANK
DIGITALLY SIGNED BY UTTAM PARAMANK
Date: 2023.12.28 14:29:45 IST

DIGITAL SIGNATURE OF A.E.(C)

DECLARATION OF GEO-TECHNICAL ENGINEER

I UNDERSTOOD HAS INSPECTED THE SITE CARRIED OUT THE SOIL INVESTIGATION THEREON IT IS CERTIFIED THAT THE EXISTING SOIL OF THE SITE IS ABLE TO CARRY THE LOAD COMING FROM THE PROPOSED CONSTRUCTION AND THE FOUNDATION SYSTEM PROPOSED HEREIN IS SAFE AND STABLE IN ALL RESPECT FROM GEO-TECHNICAL POINT OF VIEW.

BHASKAR ROY
NAME OF LICENSE NO. - G.T./12